

**Special Features**

- All SS 316 construction
- Suitable for slurry / high viscous fluids
- Flange & diaphragm are available in various type of exotic materials

**Application**

- Diaphragm seals are provided in the instruments like pressure gauges, switches, transmitters in order to isolate the sensing element from the main service due to its corrosive, viscous and sedimented nature and to avoid clogging and solidification
- These kind of seals are widely used in the viscous & corrosive services where flushing is required periodically & frequently

**Specifications**
**Standard Version (Compatible Model : AL (NS 100 mm & 150 mm))**

Range	:	For 1½" Flange : 10 kg/cm <sup>2</sup> to 250 kg/cm <sup>2</sup> **
	:	For 2" & above Flange : 1 kg/cm <sup>2</sup> to 250 kg/cm <sup>2</sup> **
Process temperature	:	-40°C to 200°C or as per fill fluid
Instrument connection	:	½" BSP (F)
Process connection	:	Flange (Refer table)
Flange finish	:	Finish 125-250 AARH

\* Range of selected instrument shall be suitable to flange pressure rating.

Diaphragm	:	AISI 316L SS
Body	:	AISI 316 SS
Flange	:	AISI 316 SS
Extension	:	50 mm (other extension on request)
Fill fluid	:	Silicon Oil - DC 200

**Range - Flange Table With Ordering Codes**
**How To Select**

e.g. For flange size of 1½" 150 class as per ANSI B 16.5 with raised face : B33 - A2

**A2** Raised Face

**A3** Flat Face

Flange Finish shall be 125 - 250 AARH as a standard. For other finish and sizes, please consult factory.

**As Per ANSI B 16.5**

NOMINAL SIZE	RATING /CLASS	CODE	NOMINAL SIZE	RATING /CLASS	CODE
1½"	150	B33	2½"	150	B45
	300	B34		300	B46
	600	B35		600	B47
	900	B36		900	B48
	1500	B37		1500	B49
	2500	B38		2500	B50
2"	150	B39	3"	150	B51
	300	B40		300	B52
	600	B41		600	B53
	900	B42		900	B54
	1500	B43		1500	B55
	2500	B44		2500	B56

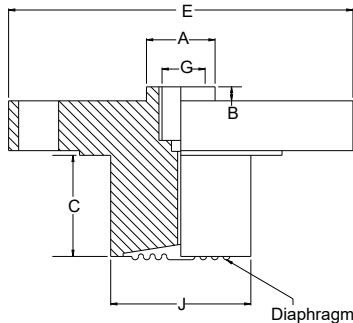
**Dimensions - Standard Version**

A	B	C	E	G	J
30	8	50*	**	1/2" BSP(F)	***

Notes : • Drawings are not to scale.  
• All Dimensions are in mm.

\* or as per customer requirement  
\*\* As per standard BLRF flange table ANSI, DIN, BS, JIS Etc.  
\*\*\* Suitable to Flange size and rating

**How To Order**
**Example**
**Basic Model**
**Code**

DL

**Optional Extras**

[It is recommended that the MOC of Diaphragm, Body &amp; Flange should be equivalent.]

**Instrument Connection**
**VM** 1/2" NPT (F)      **VL** 1/2" BSP (F) (Standard)      **VP** 3/8" BSP (F)

XX

**Diaphragm**
**UJ** AISI 316L SS (Standard)      **UM** Monel      **UL** Hastelloy 'C'

XX

**Body**
**CN** Monel      **CO** Hastelloy 'C'      **CM** AISI 316L SS      **CL** AISI 316 SS (Standard)

XX

**Body Length (Standard: 50 mm & Max. Up to 200 mm)**

Specify IN mm (e.g. 50 mm, 100 mm, 150 mm &amp; 200 mm)

100 mm

**Process Connection**

(Select code from flange table)

XXX

**Flange Material**
**TX** Monel      **TT** Hastelloy C      **TL** AISI 316L SS      **TM** AISI 316 SS (Standard)

XX

**Filling Fluids (\* Consult factory for specifications, price and delivery.)**
**UV** Food Grade Oil (OKS 370) [-10 to 180°C/14 to 356°F]      **UY** SV-Sigma Silicon Oil [-10 to 350 °C]

XX

**UX** Silicon DC 200 [-40 to 205 °C] (Standard)      **UZ** Silicon DC 710 [-5 to 371 °C]

**VC** Halocarbon Oil\*

**Remote Mounting (With capillary of Max. Up to 6 Mtrs.)**

Specify In Meters (e.g. 1.5 = 1.5 Meters 2.0 = 2 Meters)

3Mtr.

**Capillary**
**PE** AISI 304 SS      **PG** AISI 316 SS

XX

**Capillary Covered With Armour (Applicable with PE or PG if selected)**
**PF** AISI 304 SS      **PH** AISI 316 SS      **PI** PVC (Ambient Temp. Max. 60°C)

XX

**Options**
**TB** Helium Leak Test      **TC** Dry Seal Only Without Instrument      **GH** Material Test Certificates\*

XX

\* Material Test Certificates will be provided for wetted parts only with chemical composition testing. For Others, please consult factory.

**Ordering Example: DL . XX . XX . XX . 100 mm . XXX . XX . XX . 3mtr . XX . XX . XX**

For Other Optional Items, Please Contact Factory For Delivery And Minimum Quantity Of Order.

Note : Specifications and dimensions given in this product catalogue represents the state of engineering at the time of printing.

Modifications may take place and materials specified may be replaced by others without prior notice.